

HOZELOCK

4122
5102

1.25L



2

Year guarantee
Ans de garantie
Jahre Garantie
Jaar garantie
Años de garantía
Χρόνια εγγύηση

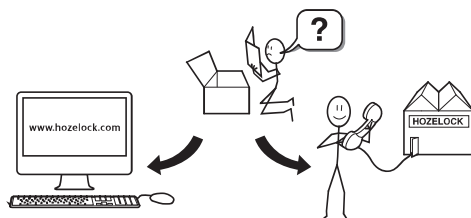

Hozelock Ltd.
Midpoint Park, Birmingham,
B76 1AB, England
Tel: +44 (0) 121 313 1122

www.hozelock.com

33799-009

Operation • Fonctionnement • Gebruik • Operación • Drift • Bedienung • Bruk • Käyttö • Drift • Funzionamento
 Funcionamento • Obsługa • Λειτουργία • Çalışma • Működés • Provoz • Эксплуатация • Kasutamine
 Lietošana • Valdymas

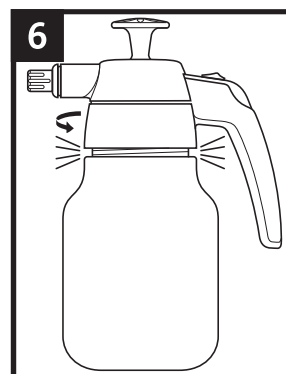
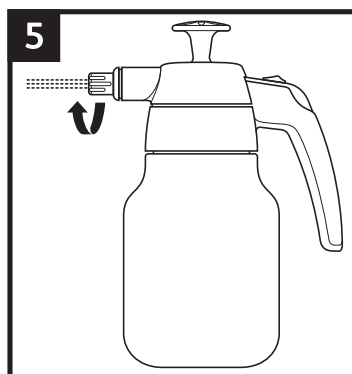
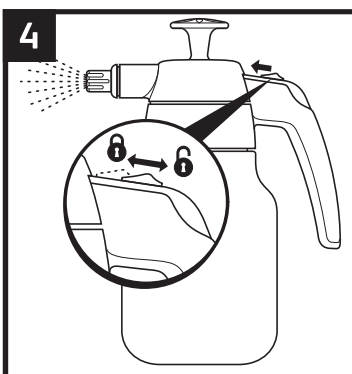
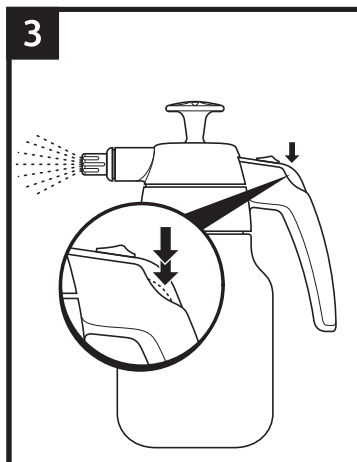
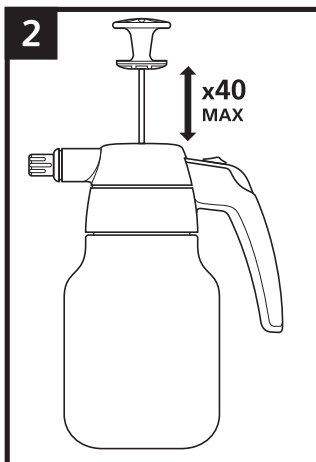
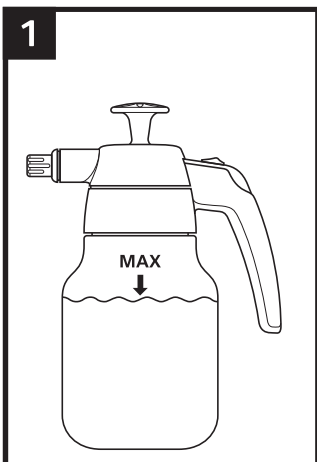

Maintenance • Entretien • Onderhoud • Mantenimiento • Underhåll • Wartung • Vedlikehold • Huolto
 Vedligehold • Manutenzione • Manutenção • Konserwacja • Συντήρηση • Bakım • Karbantartás • Údržba
 Обслуживание • Hooldus • Apkope • Remontas

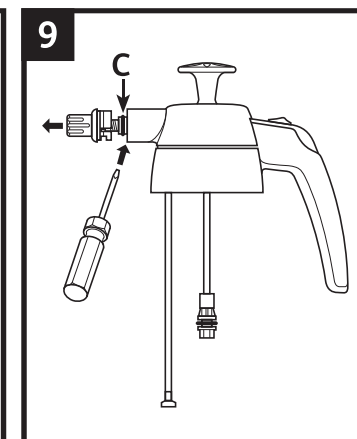
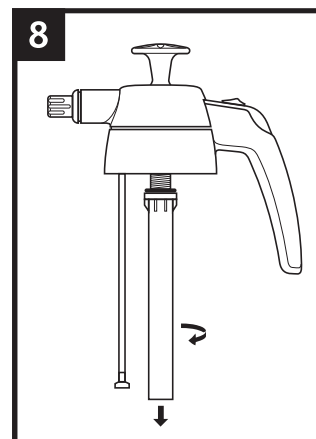
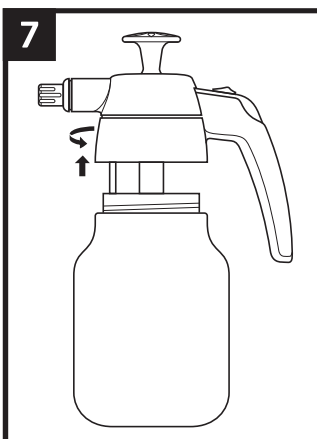

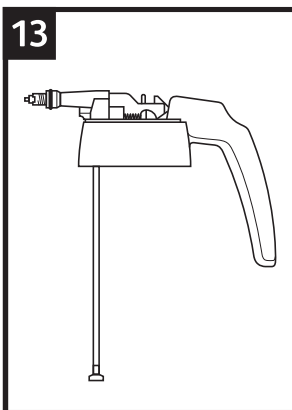
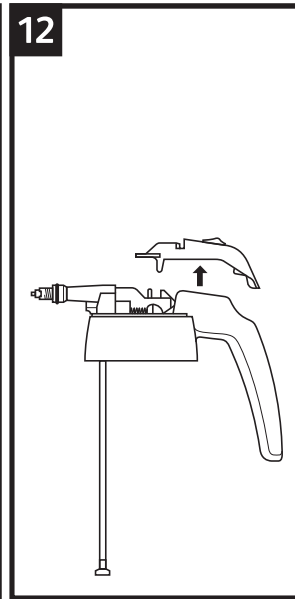
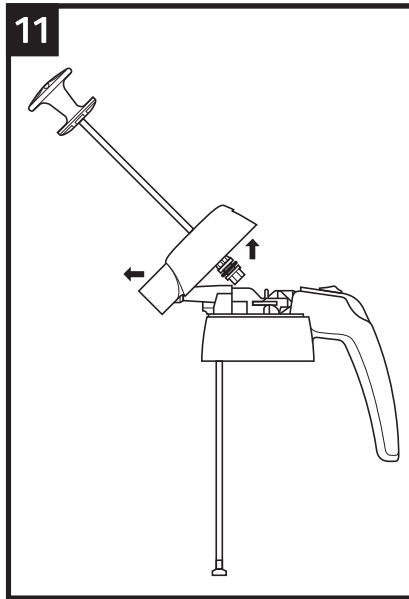
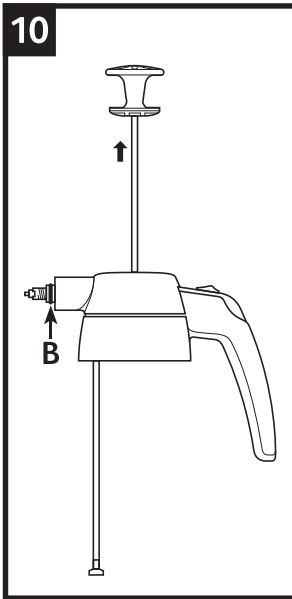

GB

Thank you for choosing a Hozelock Exel quality sprayer, you can be assured of many years of reliable service from this product.

Instructions & Warnings

- This sprayer is intended for use with water-based solutions of: insecticides, fungicides, weedkillers & fertilizers.
- Always follow the chemical suppliers instructions, as well as the instructions supplied with this sprayer.
- Check with the chemical manufacturer that their product can be applied using a sprayer.
- Nitric acid, acetic acid and propionic acid must only be used in a concentration of up to 10%, phosphoric and sulphuric acid in a concentration of up to 30%, and potassium hydroxide and caustic soda in a concentration of up to 20%.
- If other products are to be used, ensure they will not be harmful to the sprayer, people or the environment.
- Upon request, Hozelock will provide you with a list of materials used in the sprayer's components.

NOT SUITABLE FOR:

- Combustible liquids with a flashpoint below 55° C
- Acids and lyes (for exceptions see above)
- Wetting Agents (tensides)
- Viscous or sticky liquids or liquids that form residues (dyes, greases)
- Liquid with temperatures above 30° C

⚠ Always wear protective clothing, goggles, face mask and gloves.

⚠ Avoid inhaling spray mist.

⚠ Avoid skin contact with chemicals.

⚠ Always work in a well ventilated area.

⚠ Take care to protect children, pets & fish from exposure to chemicals.

⚠ Always wash hands thoroughly after use & especially before eating.

⚠ Always wash any contaminated clothing.

⚠ Seek medical attention if spray gets in your eyes or you develop any symptoms after spraying.

⚠ Do not spray near food or food preparation areas. When spraying crops, pay particular attention to the chemical manufacturers advice on time before crops can be eaten.

⚠ Do not spray any solvent e.g. White spirit.

⚠ Spray only thin watery solutions; thicker mixtures will clog the nozzle.

⚠ Powdered chemicals can be sprayed successfully if they are completely soluble in water. If they are not, or the solution tends to settle, spraying can still be successful if the mixture is continually agitated.

⚠ If the material to be sprayed contains sediment, strain the liquid into the sprayer bottle.

⚠ Winter Use – drain liquid from all parts and prevent damage from freezing.

⚠ Annual maintenance – At least once per year thoroughly clean the whole sprayer and apply silicone grease to all moving parts & seals. Test with water, and if any washer or seal has perished it must be replaced.

Notes

- Before carrying out any maintenance on this sprayer it is essential to depressurise the bottle.

A This sprayer is made from many different types of plastic, and although the liquid you wish to spray may be packed in plastic, this does not guarantee it will not damage the sprayer.

B When filling the sprayer ensure that the maximum fill level is not exceeded.

C Ensure that the pump is screwed into the bottle tightly.

D If the sprayer has been used with chemicals, discard safely any unused solution after use.

E Fill sprayer with warm water (not hot), re-assemble the sprayer and spray some of the contents. Repeat; check that the nozzle is free from sediment. If necessary repeat the process until the sprayer is clean. NB : Do not use detergent.

F The pump O-ring should be lubricated to allow the sprayer to pump air efficiently. Apply silicone grease regularly, to the pump O-Ring (A).

G The nozzle cap & swirl grooves (B) should be kept clean and free of obstruction. The O-ring should be lubricated to allow the spray pattern to be easily changed. Apply silicone grease regularly, to the nozzle O-Ring (C).

H Keep the trigger clean and free from build up of sediment and chemicals by regularly flushing after use.

Maintenance

- Winter Use – drain liquid from all parts and prevent damage from freezing.

- Annual maintenance – At least once per year thoroughly clean the whole sprayer and apply silicone grease to all moving parts & seals. Test with water, and if any washer or seal has perished it must be replaced.

- Always use eye protection when replacing valves, seals or springs

Guarantee

- Hozelock guarantees this sprayer against any defect arising from faulty materials or workmanship for a period of 2 years from the date of purchase, provided that it has only been used in accordance with these instructions. The guarantee is limited to the repair or replacement of any defective or faulty item. Proof of purchase must be retained.
- Hozelock extended guarantee covers the bottle and pump mechanism only. It specifically excludes all O-rings & seals. These have a 12-month guarantee, are wearing parts and are available as spares from the retailer or from Hozelock direct.

Statement of Warranty

General Terms and Conditions

Hozelock provides a manufacturer's warranty to the initial purchaser for each new product produced by Hozelock that is sold by an authorised Hozelock supplier in Australia or New Zealand. This warranty provides such initial purchaser with a guarantee against faulty workmanship in manufacture and/or defective components for the warranty period from the date of purchase.

The benefits given by this manufacturer's warranty are in addition to other rights and remedies of the consumer under a law in relation to the goods to which this warranty relates.

Making a Claim

If any product supplied by Hozelock is found to be defective due to faulty manufacture and/or defective components within the warranty period, Hozelock will repair or replace the product to the customer providing:

- proof of purchase is provided to Hozelock or its authorized supplier of the relevant goods.
- the fault is not caused by misuse, neglect, adjustments and/or modification by the consumer.
- the consumer presents the defective product at the premises of the authorised supplier of that relevant Hozelock product.
- failure has not occurred through normal wear and tear.

The product will be repaired or replaced at Hozelock's cost however any costs incurred to obtain warranty consideration or service is the consumer's responsibility, including shipping and handling, travel expense, lost time, or pick up and delivery.

Australia

Our goods come with guarantees that cannot be excluded under the Australia Consumer Law. You are entitled to a replacement or refund for a major failure and for compensation for any other reasonably foreseeable loss or damage. You are also entitled to have the goods repaired or replaced if the goods fail to be of acceptable quality and the failure does not amount to a major failure.

This warranty is provided by
Hozelock Australia Pty Ltd (ABN 83 154 891 648).
Unit 22 / 456 St Kilda Road, Melbourne, Victoria 3004.

Phone: 1300 275175

Email: australi@mail@hozelock.com

New Zealand

The manufacturer's warranty is in addition to the rights and remedies provided by the New Zealand Consumer Guarantees Act.

Distributed in New Zealand by:
Horticom (Company No. 463657)

651 Rosebank Road, Avondale, Auckland 1026.

Phone: 09 828 4408

Contact Details

For product advice please contact:

Hozelock Consumer Services,
Hozelock Ltd., Midpoint Park, Birmingham, B76 1AB.

Tel: 0121 313 1122

www.hozelock.com

Troubleshooting

Issue	Problem	Solution
Weak or no spray	Sprayer will not pressurise	Ensure all connections are tight
	Loss of pressure	Check 'O'-rings and seals are lubricated and show no signs of wear or damage – replace if required (see notes F, G and H)
	Obstruction	There could be a blockage in the nozzle, the trigger or the outlet hose
Distorted Spray	Obstruction	There could be debris in the nozzle
Leaks	Build up of sediment or foreign matter on sealing surfaces	Check 'O'-rings and seals are free from dirt – Clean or replace if required
	Worn or damaged 'O' rings or washers.	Check 'O'-rings and seals are free from wear or damage – replace if required
Handle rises	Faulty non return valve	This stops the compressed air in the container from escaping back into the pump If faulty, the pump handle will rise when the container is pressurized. To remove the valve, lift the edge and pull (NB take care not to damage the sealing face of the barrel. Replace with a new valve by pushing firmly over the centre hole)

F

Merci d'avoir choisi un pulvérisateur de qualité Hozelock. Vous avez la garantie de nombreuses années de service fiable avec ce produit.

Instructions & Avertissements

- Ce pulvérisateur est destiné à être utilisé pour des solutions à base d'eau, d'insecticides, de fongicides, de désherbants & de fertilisants
- Il est impératif de suivre les instructions du fournisseur des produits chimiques, ainsi que les instructions fournies avec ce pulvérisateur
- Vérifier auprès du fabricant du produit chimique que ce dernier peut être appliqué à l'aide d'un pulvérisateur.



Hozelock Ltd.

Midpoint Park, Birmingham, B76 1AB. England

Tel: +44 (0) 121 313 1122

Hozelock Australia Pty Ltd (ABN 83 154 891 648).

Unit 22 / 456 St Kilda Road, Melbourne, Victoria 3004.

Phone: 1300 275175

Email: australi@mail@hozelock.com

www.hozelock.com

33799-009