

HOZELOCK

4507
4510

5L & 8L

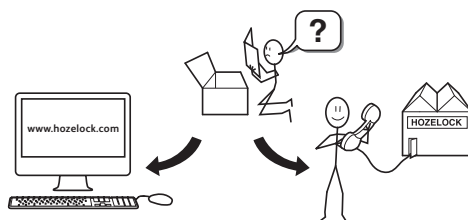

Hozelock Ltd.
Midpoint Park, Birmingham,
B76 1AB, England
Tel: +44 (0) 121 313 1122

www.hozelock.com

33892-004

Contents

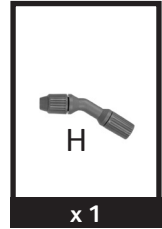
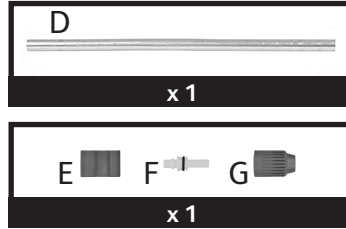
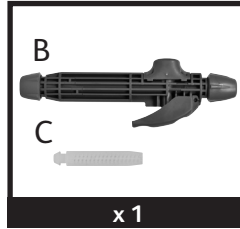
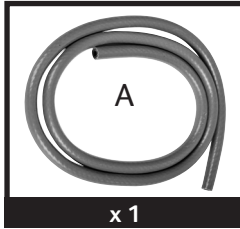

Assembly

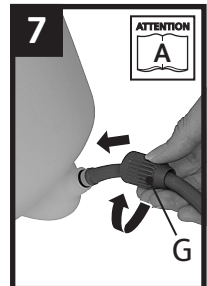
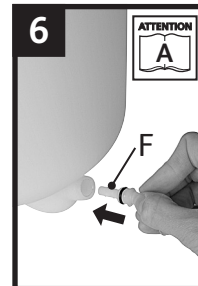
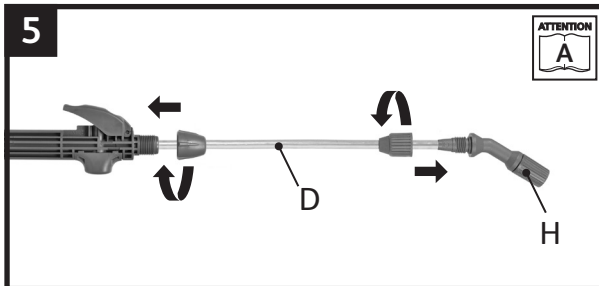
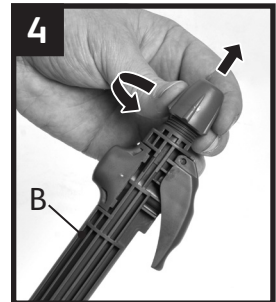
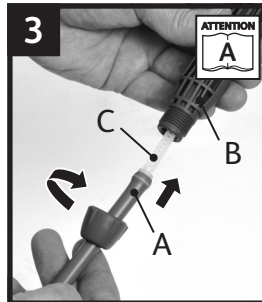
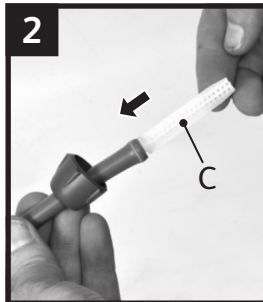

Operation

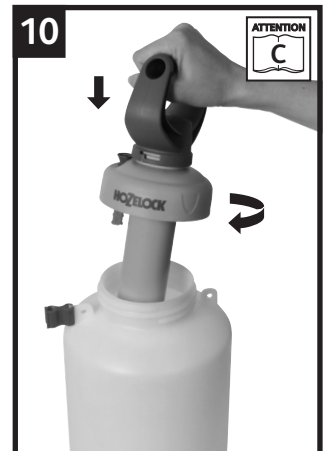

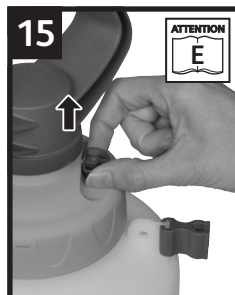
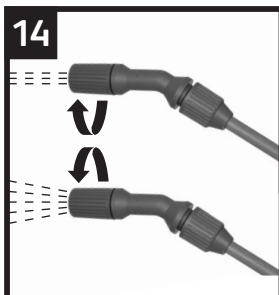
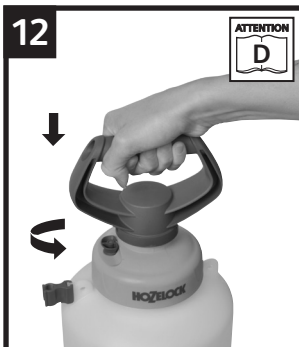

Maintenance



Maintenance

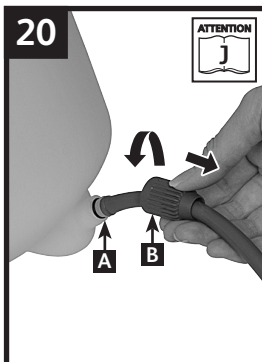
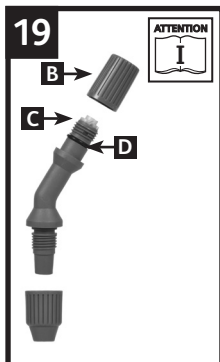

GB

Thank you for choosing a Hozelock quality sprayer, you can be assured of many years of reliable service from this product.

Instructions & Warnings

- This sprayer is intended for use with water-based solutions of: insecticides, fungicides, weedkillers and fertilizers.
 - Always follow the chemical suppliers instructions, as well as the instructions supplied with this sprayer.
 - Make sure all nuts are screwed hand tight before use.
 - If the sprayer has been used with chemicals, discard safely any unused solution after use.
 - Always use eye protection when replacing valves, seals or springs
 - **Before carrying out any maintenance on this sprayer it is essential to depressurize the bottle, by lifting the pressure release knob.**
- ⚠ Always wear protective clothing, goggles, face mask and gloves.**
- ⚠ Avoid inhaling spray mist.**
- ⚠ Avoid skin contact with chemicals.**
- ⚠ Always work in a well ventilated area.**
- ⚠ Take care to protect children, pets & fish from exposure to chemicals.**
- ⚠ Always wash hands thoroughly after use & especially before eating.**
- ⚠ Always wash any contaminated clothing.**
- ⚠ Seek medical attention if spray gets in your eyes or you develop any symptoms after spraying.**
- ⚠ Do not spray near food or food preparation areas. When spraying crops, pay particular attention to the chemical manufacturers advice on time before crops can be eaten.**
- ⚠ Do not spray any solvent e.g. White spirit.**
- ⚠ Spray only thin watery solutions; thicker mixtures will clog the nozzle.**
- ⚠ Powdered chemicals can be sprayed successfully if they are completely soluble in water. If they are not, or the solution tends to settle, spraying can still be successful if the mixture is continually agitated.**

- ⚠ If the material to be sprayed contains sediment, strain the liquid into the sprayer bottle.**
- ⚠ Do not over pressurize the bottle. The pressure release valve is designed to release excess pressure, and must not be tampered with, or forced to remain closed.**
- ⚠ Winter use – drain liquid from all parts and loosen pump assembly.**
- ⚠ Annual maintenance – At least once per year thoroughly clean the whole sprayer and apply silicone grease to all moving parts & seals. Test with water, and if any washer or seal has perished it must be replaced.**

Notes

- A** Ensure the hose fully covers the barbed details on both the lance, and the outlet connection. Make sure all nuts are hand tight before use.
- B** This sprayer is made from many types of plastic, and although the liquid you wish to spray may also be packed in plastic, this does not guarantee it will not damage the sprayer. If you have any doubt about compatibility, contact Hozelock consumer services. When filling the sprayer ensure that the maximum fill level is not exceeded.
- C** Ensure that the pump is screwed into the bottle tightly and locked in position.
- D** **Before operating the pump, operate the pressure release valve manually by lifting the knob to ensure it is free to move, then release the handle by rotating anticlockwise, pressurise bottle and then lock back in position.**
- E** After using the sprayer, manually operate the pressure release valve as above, to depressurize.
- F** If the sprayer has been used with chemicals discard any unused solution in an environmentally friendly manner.
- G** Fill bottle with warm (not hot) water, reassemble the sprayer, and spray some of the contents. Repeat, and check that the nozzle is free from sediment. If necessary, repeat the process until the sprayer is clean. NB: Do not use detergent.
- H** The pump assembly and pressure release valve o rings should be lubricated to allow the sprayer to pump air efficiently. Access the seals by unscrewing the plunger retaining ring. Apply silicone grease regularly to the pump, piston and release valve o ring seals (A).
- I** The nozzle cap (B) and swirl grooves (C) should be kept clean and free of obstructions. The o ring seal (D) should be lubricated with silicone grease to allow the spray pattern to be easily changed.
- J** To clean or replace the outlet o ring seal, unscrew the retaining nut (B), and pull out the spigot (A).

Guarantee

- Hozelock guarantees this sprayer against any defect arising from faulty materials or workmanship for a period of 2 years from the date of purchase, provided that it has only been used in accordance with these instructions. The guarantee is limited to the repair or replacement of any defective or faulty item. Proof of purchase must be retained.
- The Hozelock guarantee also covers 'O' rings and seals for a 12-month period, as these are wearing parts, they are available as spares from the retailer or from Hozelock direct.

Statement of Warranty

General Terms and Conditions

Hozelock provides a manufacturer's warranty to the initial purchaser for each new product produced by Hozelock that is sold by an authorised Hozelock supplier in Australia. This warranty provides such initial purchaser with a guarantee against faulty workmanship in manufacture and/or defective components for the warranty period from the date of purchase.

The benefits given by this manufacturer's warranty are in addition to other rights and remedies of the consumer under a law in relation to the goods to which this warranty relates.

Making a Claim

If any product supplied by Hozelock is found to be defective due to faulty manufacture and/or defective components within the warranty period, Hozelock will repair or replace the product to the customer providing:

- proof of purchase is provided to Hozelock or its authorised supplier of the relevant goods
- the fault is not caused by misuse, neglect, adjustments and or modification by the consumer
- the consumer presents the defective product at the premises of the authorised supplier of that relevant Hozelock product
- failure has not occurred through normal wear and tear

The product will be repaired or replaced at Hozelock's cost however any costs incurred to obtain warranty consideration or service is the consumer's responsibility, including shipping and handling, travel expense, lost time, or pick up and delivery.

Australia

Our goods come with guarantees that cannot be excluded under the Australia Consumer Law. You are entitled to a replacement or refund for a major failure and for compensation for any other reasonably foreseeable loss or damage. You are also entitled to have the goods repaired or replaced if the goods fail to be of acceptable quality and the failure does not amount to a major failure.

Hozelock Australia Pty Ltd (ABN 83 154 891 648).

Unit 22 / 456 St Kilda Road, Melbourne, Victoria 3004

Phone: 1300 275175 Email: australiamaail@hozelock.com

New Zealand

The manufacturer's warranty is in addition to the rights and remedies provided by the New Zealand Consumer Guarantees Act

Distributed in New Zealand by:

Horticom (Company No. 463657)

651 Rosebank Road, Avondale, Auckland 1026

Troubleshooting

Issue	Problem	Solution
Weak or no spray	Sprayer will not pressurise	Ensure all connections are tight
	Loss of pressure	Check 'O'-rings and seals are lubricated and show no signs of wear or damage – replace if required (see notes H, I and J)
	Obstruction	There could be a blockage in the nozzle, the trigger or the outlet hose
Distorted Spray	Obstruction	There could be debris in the nozzle
Leaks	Build up of sediment or foreign matter on sealing surfaces	Check 'O'-rings and seals are free from dirt – Clean or replace if required
	Worn or damaged 'O' rings or washers.	Check 'O'-rings and seals are free from wear or damage – replace if required
Handle rises	Faulty non return valve	This stops the compressed air in the container from escaping back into the pump If faulty, the pump handle will rise when the container is pressurized. To remove the valve, lift the edge and pull (NB take care not to damage the sealing face of the barrel. Replace with a new valve by pushing firmly over the centre hole)

Spares and Accessories

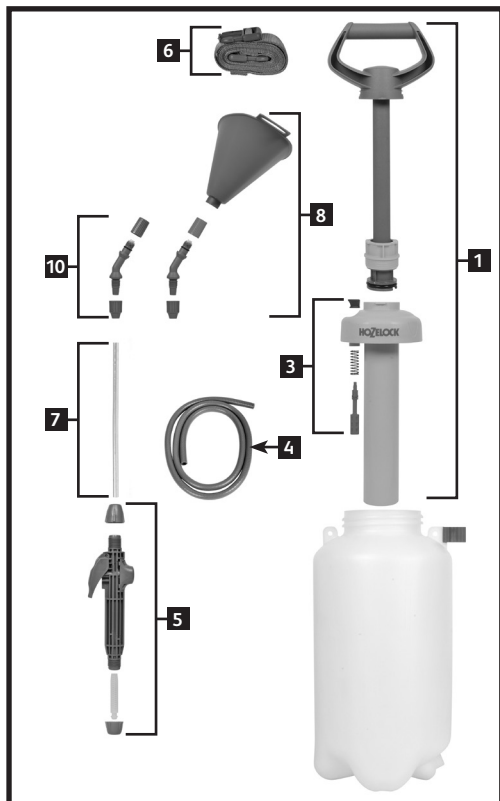

1 Complete pump assembly - Part No. 4128

2 Outlet kit - Part No. 4130

3 Pressure release valve assy - Part No. 4132

4 1.5m hose (PVC) - Part No. 4099

5 Trigger assembly - Part No. 4134

6 Strap assembly - Part No. 4136

7 Lance assembly - Part No. 4106

8 Weedkiller cone with fanspray angled head assembly
- Part No. 4112

9 Annual service kit - Part No. 4125

10 Replacement nozzle kit (jet and fan) - Part No. 4103

Please go to www.hozelock.com for details of spares and accessories available.



HOZELOCK

Hozelock Ltd.

Midpoint Park, Birmingham, B76 1AB. England

Tel: +44 (0) 121 313 1122

Hozelock Australia Pty Ltd (ABN 83 154 891 648).

Unit 22 / 456 St Kilda Road, Melbourne, Victoria 3004

Phone: 1300 275175

Email: australiamail@hazelock.com

www.hozelock.com

33892-004